



FAC GALLERY

EXHIBITION APPLICATION

ABOUT

The FAC Gallery represents professional artists working in all media, including painting, collage, sculpture, mixed media, fiber, and photography.

Currently scheduling exhibitions, the FAC Gallery is looking for **two-person or group shows**. Exhibitions are displayed for 6 - 8 weeks and include a reception. The gallery charges a 35% commission on all sales.

APPLY

Artists may mail their portfolios with SASE & exhibition proposal to:

EXHIBITION PROPOSALS
FAC GALLERY
444 SOUTH FLOOD AVENUE
NORMAN, OKLAHOMA 73069

Artists may also drop off the exhibition application, materials and their portfolios at the gallery during gallery hours (Monday - Friday, 9:30 am - 5:30 pm and Saturday, 10 am - 4pm).

The gallery committee meets 2 - 3 times a year; a representative will notify you as soon as possible of the gallery committee's decision.

SUBMISSIONS

Submissions will not be considered without the following information for **all artists involved** in the proposed exhibition:

- Group Cover Letter and Exhibition Proposal along with statement as to why the artists feel this exhibition should be shown at the FAC.
- Resume
- Individual Artist Statements
- Artist Bio
- Portfolio CD (with no more than 20 images)
Images must be labeled with the artwork's title and be high quality .jpg files, with a resolution of at least 300 DPI.
- Corresponding portfolio image list
List must include the work's title, medium, date of creation, dimensions, and price.
- SASE Large enough to hold all contents if you wish your submission to be returned, or submission will not be returned.

For each exhibition, the gallery will provide:

- Hanging and installation of the exhibition by the FAC Curator
- Postcard Invite Mailing
- Email & Social Media promotion
- Promotion on the FAC website
- Press Releases to area media
- Exhibition guide
- Processing of sales transactions
- Exhibition reception

The FAC Gallery will exercise professional care in handling all portfolio materials but cannot assume liability for any loss or damages while in the possession of the Firehouse Art Center.

Due to the large number of submissions we receive, please understand that it is not always possible for the gallery to critique work on an individual basis.

Thank you for your interest in the FAC Gallery.

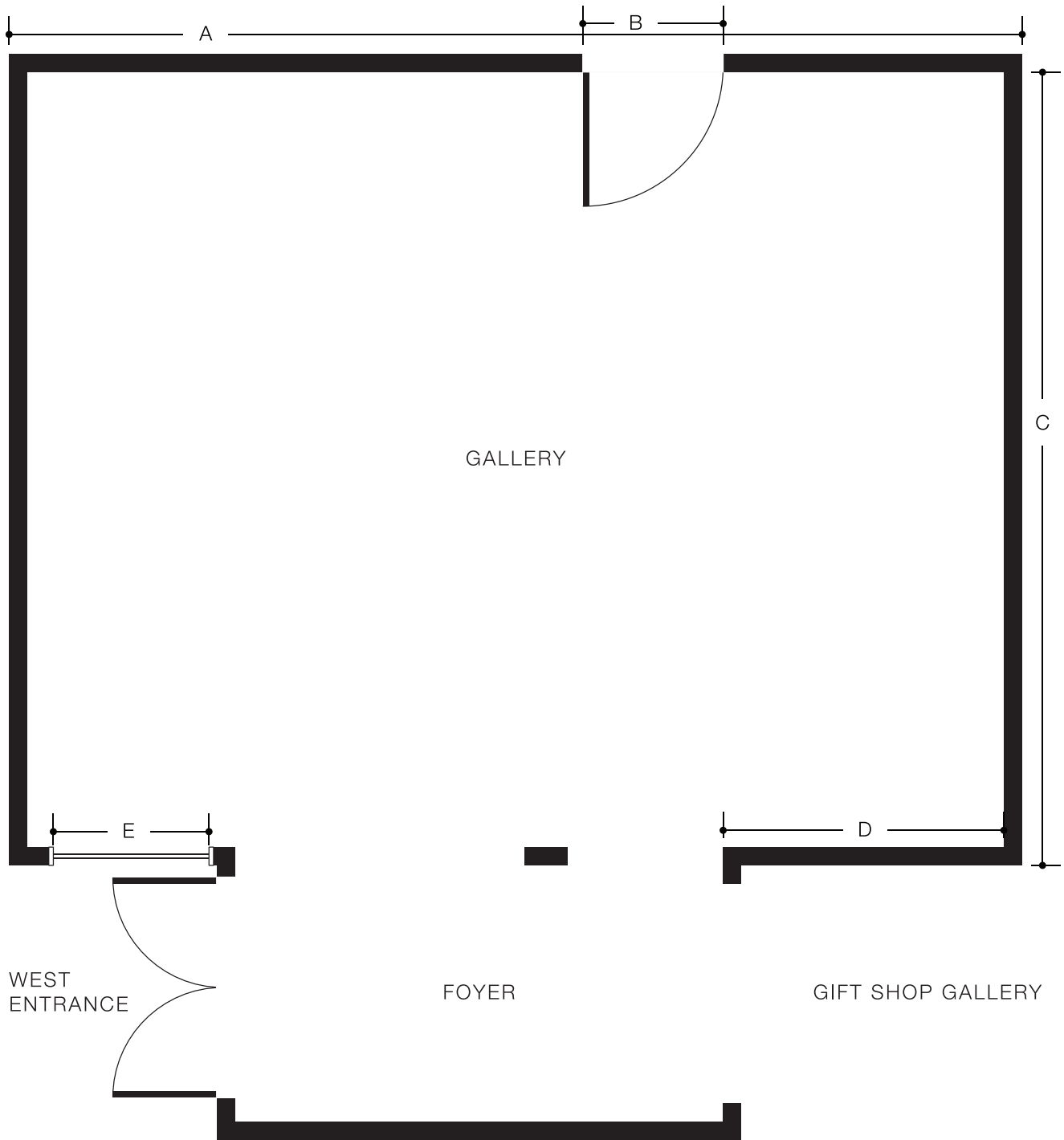

FAC GALLERY
EXHIBITION SPACE

- A** 26ft 8in - total wall space
- B** 3ft 10in - closet door, usable for hanging work
- C** 21ft 2in - total wall space
- D** 7ft 8in - total wall space
- E** 4ft 3 in wide x 6ft 5in tall window

Ceilings 9ft 10in
Foyer 7ft 6in x 13ft 4in

Exhibition to be arranged at the discretion of the FAC Curator.